



Eveready Battery Company, Inc.

533 Maryville University Drive  
 St. Louis, MO 63141  
 Telephone 1-800-383-7323  
 Internet: www.energizer.com

## Engineering Data

**D**  
**Rechargeable 1.2V**  
**Nickel-Cadmium**

### ENERGIZER NO. CH50

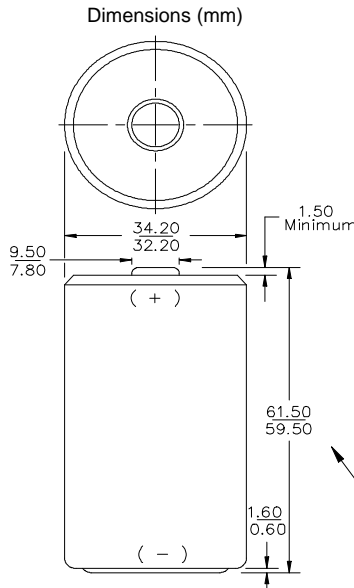

Millimeters	Inches
0.60	0.024
1.50	0.059
1.60	0.063
7.80	0.307
9.50	0.374
32.20	1.268
34.20	1.346
59.50	2.343
61.50	2.421

This dimension applies to contact to contact

**Chemical System:** Nickel-Cadmium (NiCd)

**Designation:** ANSI / NEDA-10013, IEC-KR35/82

**Battery Voltage:** 1.2 Volts

**Average Weight:** 67 grams (2.4 oz.)

**Volume:** 56.5 cubic centimeters (3.5 cubic inch)

**Terminals:** Flat Contact

**Rated Capacity: (to 1.0 Volt):** 1.8 Ah

(Based on 360 mA (0.2C) discharge rate)

**Maximum Charge Rate:** 540 mA

**Cell:** One "sub C" in "D" size container

**Jacket:** Plastic Label

#### Internal resistance

The internal resistance of the cell varies with state of charge, as follows:

<u>Cell Charged</u>	<u>Cell 1/2 Discharged</u>
20 milliohms	30 milliohms
(Tolerance of ±20% applies to above values)	

#### AC Impedance (No Load)

The impedance of the charged cell varies with frequency, as follows:

<u>Frequency (Hz)</u>	<u>Impedance (milliohms)</u> (Charged Cell)
50	12
1000	11
10000	14

Note: Above values based on AC current set at 1.0 ampere.  
 Value tolerances are ±20%

#### **TYPICAL DISCHARGE CHARACTERISTICS** Average Performance at 21°C (70°F)

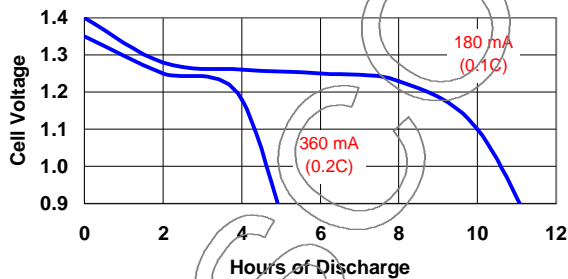

#### **TYPICAL DISCHARGE CHARACTERISTICS** Average Performance at 21°C (70°F)

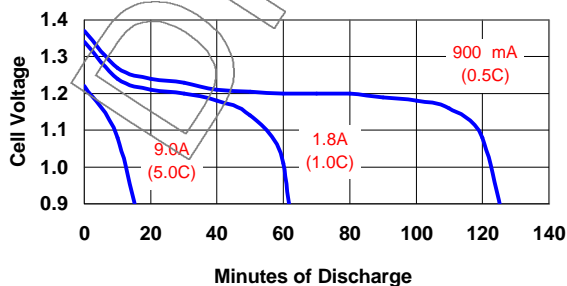

#### Operating and Storage Temperatures

Ranges of temperature applicable to operation of the CH50 cells are:

<b>Charge @ 0.1C:</b>	32°F to 122°F (0°C to 50°C)
<b>Discharge @ 0.1C:</b>	-4°F to 122°F (-20°C to 50°C)
<b>Storage:</b>	-40°F to 140°F (-40°C to 60°C) (6 Months Max.) -4°F to 95°F (-20°C to 35°C) (2 Years Max.)

Operating at extreme temperature will significantly effect service and cycle life.

#### Important Notice

This data sheet contains information specific to batteries manufactured at time of its publication. Please contact your Energizer representative for most current information. Contents herein do not constitute a warranty.