

Eveready Super Heavy Duty (3LR12)

**4.5V**



**Specifications**

<b>Classification:</b>	"Carbon Zinc" (Zinc Chloride)
<b>Chemical System:</b>	Zinc-Manganese Dioxide (Zn/MnO <sub>2</sub> ) No Added Mercury or Cadmium
<b>Designation:</b>	IEC-3R12
<b>Nominal Voltage:</b>	4.5 volts
<b>Operating Temp:</b>	-5°C to 55°C
<b>Typical Weight:</b>	163 grams
<b>Typical Volume:</b>	77 cubic centimeters
<b>Jacket:</b>	Plastic Label
<b>Terminals:</b>	Spring Clips

**Industry Standard Dimensions**

(millimeters)

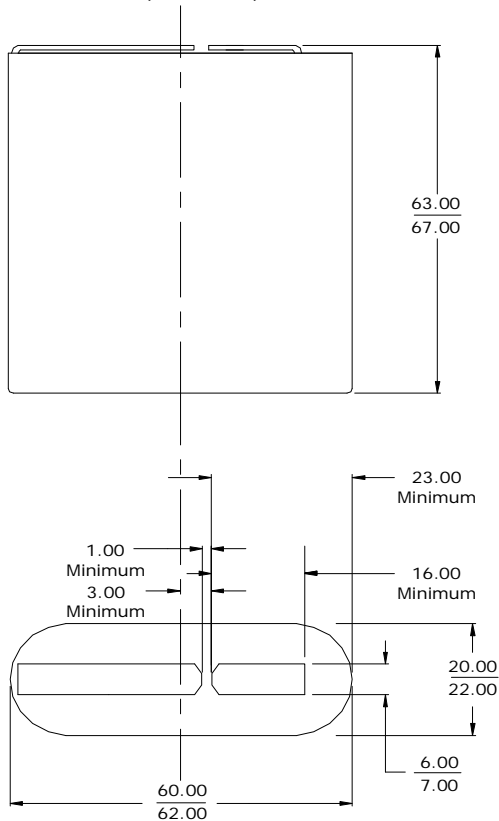

**Industry Standard Tests (21°C)**

**FLASHLIGHT**  
24 ohm 1 hr/day

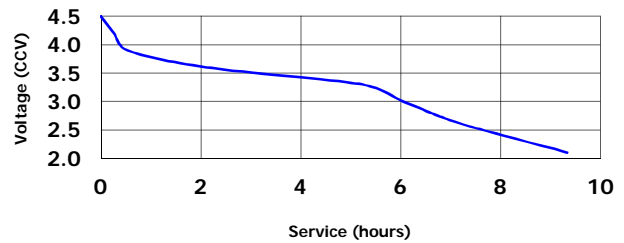

**RADIO**  
220 ohm 4 hrs/day

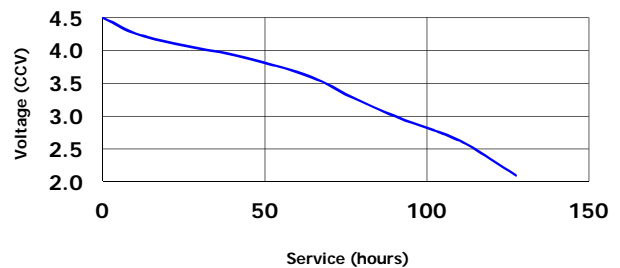

**Important Notice**

This datasheet contains typical information specific to products manufactured at the time of its publication.  
©Energizer Holdings, Inc. - Contents herein do not constitute a warranty.