

Eveready Silver 9V (6F22)

**9V**



**Industry Standard Dimensions**

(millimeters)

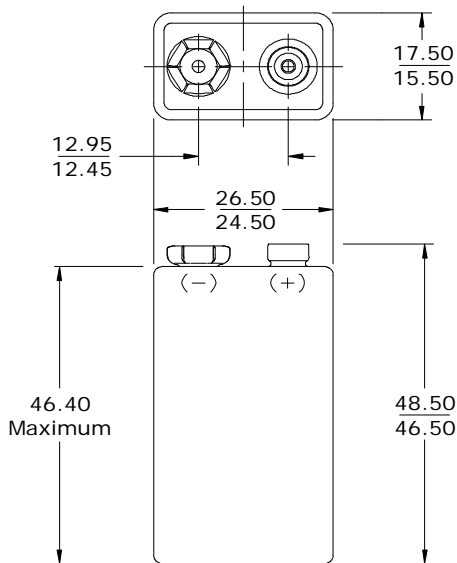

**Specifications**

<b>Classification:</b>	"Carbon Zinc" (Zinc Chloride)
<b>Chemical System:</b>	Zinc-Manganese Dioxide (Zn/MnO <sub>2</sub> ) No Added Mercury or Cadmium
<b>Designation:</b>	IEC-6F22
<b>Nominal Voltage:</b>	9.0 volts
<b>Typical Capacity:</b>	400 mAh* (to 4.8 volts)
<b>Capacity Test:</b>	5 mA continuous drain (21°C)

\* Varies according to the applied load, temperature, and cutoff voltage.

<b>Operating Temp:</b>	-5°C to 55°C
<b>Typical Weight:</b>	37 grams
<b>Typical Volume:</b>	20.3 cubic centimeters
<b>Jacket:</b>	Metal

**Storage/Capacity Characteristics**

Effects of Storage at Various Temperatures

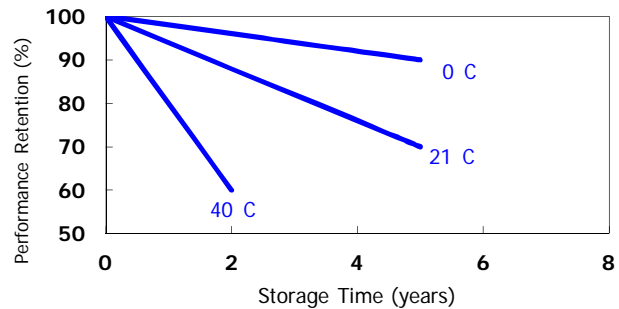

**Industry Standard Tests (21°C)**

**RADIO**

620 ohm 2 hrs/day

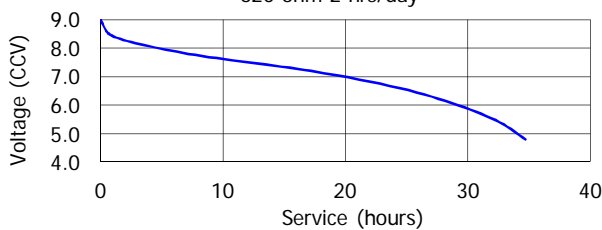

**TOY**

270 ohm 1 hr/day

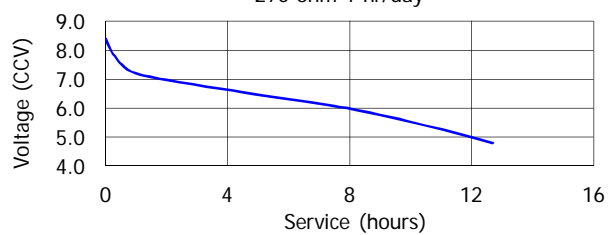

**CALCULATOR**

180 ohm 0.5 hr/day

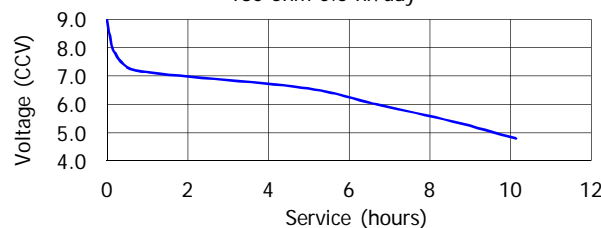

**Important Notice**

This datasheet contains information specific to battery chargers manufactured at the time of its publication.  
 © Energizer Holdings, Inc. - Contents herein do not constitute a warranty.